

FOR SALE

RESIDENTIAL - CONDOMINIUM 441SQFT (41SQM) / CALL FOR PRICE!

+65 9026 6884



1 - Bedroom

TYPE (1)a
#05-02 to #08-02
#05-05* to #08-06*
41 sq m
incl. A/C ledge 2 sq m,
Balcony 5 sq m 5 sq m

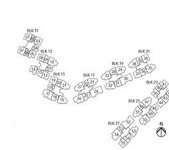

RESIDENTIAL - CONDOMINIUM

**THE JOVELL, 11,13,15,17,19,21,23,25,27 FLORA DRIVE,
CHANGI AIRPORT, CHANGI VILLAGE, SINGAPORE**

- **LISTING ID:** SGLD52920744
- **TENURE:** LEASEHOLD 99
- **TITLE:** N/A
- **SIZE BUILT-UP:** 441SQFT (41SQM)
- **SIZE LAND:** N/A
- **NO. OF FLOORS:** 8
- **FLOOR/LEVEL:** N/A - MIDDLE FLOOR
- **BED ROOMS:** 1
- **BATH ROOMS:** 1
- **MAIDS ROOMS:** N/A
- **PARKING SPACES:** N/A
- **LAYOUT TYPE:** OTHER
- **FACING:** N/A
- **VIEWING:** N/A
- **SELLING PRICE:** **CALL FOR PRICE!**
- **COMPLETION YEAR:** 2022
- **CONDITION:** ORIGINAL CONDITION
- **FURNISHING:** PARTIALLY FURNISHED
- **LISTING DATE:** JUL 05, 2019

THE JOVELL

Condominium for Sale: Partially furnished. 1 bedroom, 1 bathroom. Completed in 2022, this unit is in original condition. Tenure: Leasehold 99 Located in Singapore's district D17 near Changi Airport, Changi Village in the area Far East (East region).

INTERIOR FACILITIES

- Air-Conditioning
- Cable TV
- Balcony
- Fiber-Internet

OTHER INTERIOR FEATURES

- Cooker Hob/Hood
- Intercom
- Fridge
- Oven / Microwave

EXTERIOR FACILITIES

- 24 Hours Security
- Function Room
- Covered Car Park
- Jacuzzi

VISIT THIS PROPERTY AT: <https://www.dennisnghuttons.com/property/SGLD52920744>

DENNIS NG - HUTTONS ASIA PTE LTD

3 Bishan Place #05-01 CPF Bishan Building
D20, 579838, Singapore

+65 9026 6884
WhatsApp Me

dennisngwk@gmail.com

<https://www.dennisnghuttons.com>



Scan QR Code

Huttons® Call for Viewing
The Agency of Choice +65-90266884